

Actuator

MD53



Features

- ◆ MD53 is a compact and powerful actuator designed for healthcare equipment application. It is an ideal solution for applications requiring high force and small installation dimension.
- ◆ Main applications : homecare and industrial
- ◆ Input voltage : 36V DC / 24V DC
- ◆ Max. load : 3500N (push) / 2000N (pull)
- ◆ Max. current : 4A @ 36V DC
- ◆ Max. speed : 10.5 mm/sec @ no load
- ◆ Stroke : 100~300 mm
- ◆ Duty cycle : 10% or 2 min continuous operation in 20 min.
- ◆ Color : Black
- ◆ Noise level : \leq 60dB
- ◆ Preset limit switches

Options

- ◆ Potentiometer

Compatibility

1. Control box

T Control (without potentiometer), CIS3 (with potentiometer)

2. Accessory

NA

Performance Data

Model No.	Push Max. (N)	Pull Max. (N)	Speed (mm/s)		Current (A)	
			No load	Full load	No load	Full load
MD53-24-XXX.XXX-CXX	3500	2000	10.5	8.5	1	4.5
MD53-36-XXX.XXX-CXX	3500	2000	10.5	8.5	0.8	3.5

Speed vs Load

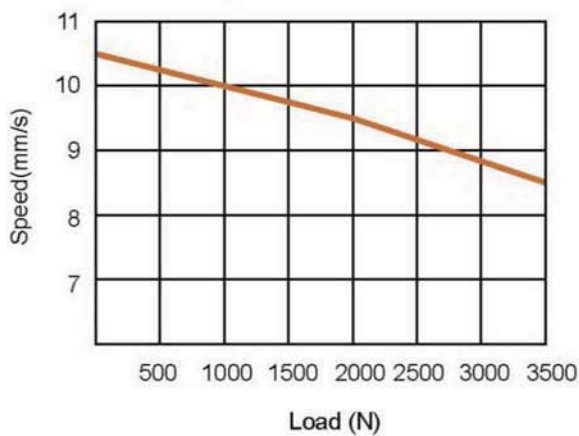

Current vs Load

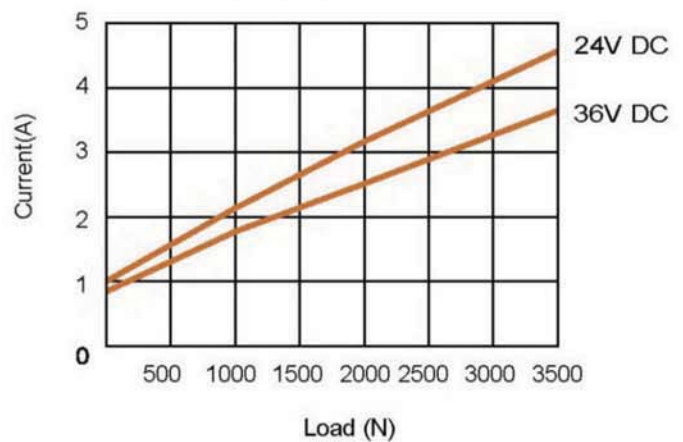

Dimension

L=750

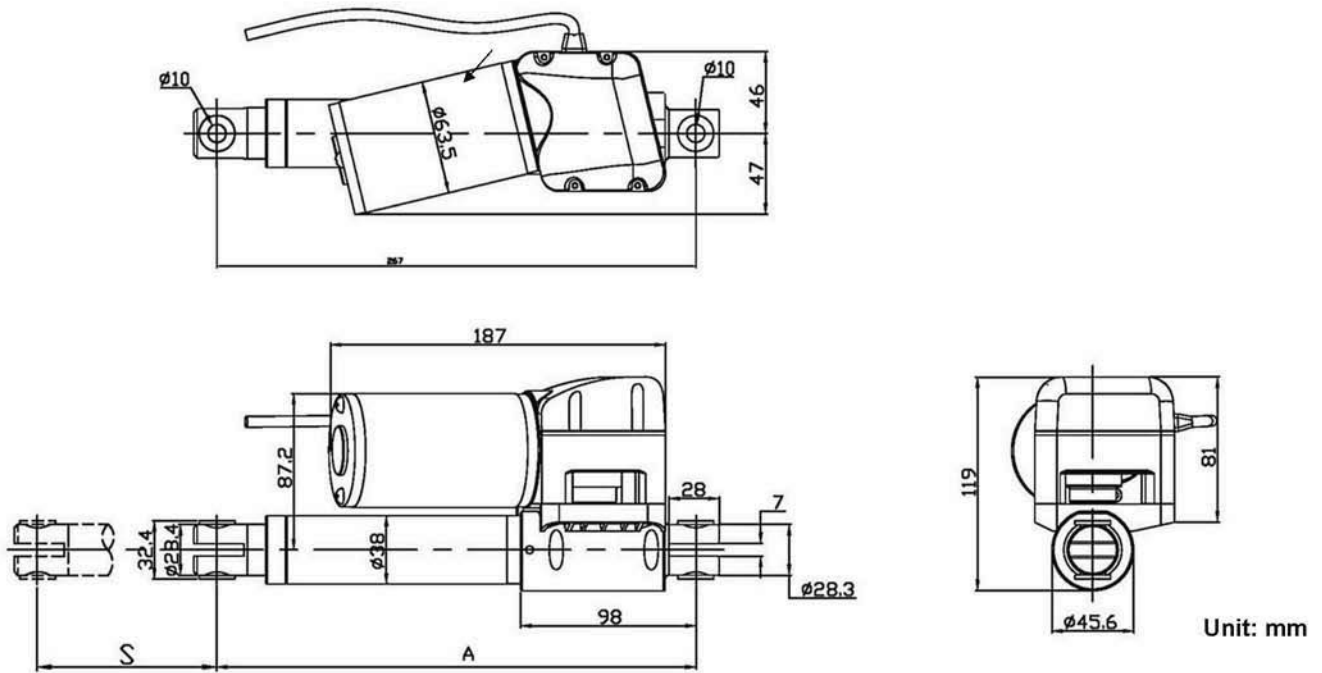

Unit: mm

Unit : mm

Stroke (S)	100	150	200	250	300
Retracted Length (A±5mm)	267	317	367	417	467

◆ Front Connector

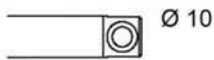

C1x

Metal + Nylon
bushing

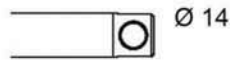

C2x

Metal

◆ Rear Connector

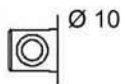

Cx1

Metal + Nylon
bushing

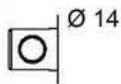

Cx2

Metal

Wiring

1. Standard Type

Wire color	Extended	Retracted
Red	(+)	(-)
Black	(-)	(+)

2. With Potentiometer

Wire color	Extended	Retracted
Red	(+)	(-)
Black	(-)	(+)
Yellow	V (input)	
Blue	RS (output)	
White	GND	

3. Resistance value of potentiometer (between blue and white wires)

Stroke	Resistance
100 mm	428 (Ω)
150 mm	642 (Ω)
200 mm	856 (Ω)
250 mm	785 (Ω)
300 mm	879 (Ω)

Ordering Key

MD53—□□—□□□.□□□—C□□—□□□

Input Voltage

36 : 36V DC

24 : 24V DC

A : Retracted Length

B : Extended Length

Front Connector

1 : Metal + Nylon bushing

2 : Metal

Rear Connector

1 : Metal + Nylon bushing

2 : Metal

Option

POT : Potentiometer



北京泰瑞恩商贸有限公司
Beijing Torion Trading Co.,Ltd.

Tel:13801253818 Fax:010-84067150
www.torion.cn sales@torion.cn