

Actuator

FD20



Features

- ◆ FD20 is a compact and quiet actuator designed for use in furniture, homecare and fitness equipment. To meet various application needs, there are several models with different speed and load for customer to choose.
- ◆ Main applications : Furniture, homecare and fitness equipment.
- ◆ Input voltage : 24V DC
- ◆ Max. load : 2000N (push / pull)
- ◆ Max. current : 3.2A @ 24V DC
- ◆ Max. speed at no load : 33.2 mm/sec
- ◆ Max. speed at full load : 6.5 mm/sec @ 2000N
- ◆ Stroke : 50 ~ 250 mm
- ◆ Duty cycle : 10% or 2 min continuous operation in 20 min.
- ◆ IP Protection level : IP42
- ◆ Color : Black
- ◆ Certified : EN55014-1
- ◆ Noise Level : ≤ 53 dB
- ◆ Preset limit switches

Options

- ◆ Positioning signal feedback with Hall effect sensor x 1
- ◆ Positioning signal feedback with Hall effect sensor x 2

Compatibility

1. Control box

T control, TR11, TL01, CS1, CB3T, CB4M

2. Handset

HA, HC, HD, HJ, HM, H2N, H3N

3. Accessory

None

Performance Data

Model No.	Push Load Max. (N)	Pull Load Max. (N)	Speed (mm/s)		Current (A) @ 24V DC	
			No load	Full load	No load	Full load
FD20-XX-A3- XXX.XXX	2000	2000	4.3	3.3	0.3	1.2
FD20-XX-A4- XXX.XXX	2000	2000	5.6	4.0	0.3	1.5
FD20-XX-A6- XXX.XXX	2000	2000	8.2	4.7	0.3	2.2
FD20-XX-K3- XXX.XXX	2000	2000	8.5	5.6	0.4	1.9
FD20-XX-K4- XXX.XXX	2000	2000	10.8	6.3	0.4	2.2
FD20-XX-A8- XXX.XXX	2000	2000	11.5	6.5	0.3	2.0
FD20-XX-K6- XXX.XXX	1500	1500	16.2	7.8	0.4	2.6
FD20-XX-AC- XXX.XXX	1500	1500	16.9	8.6	0.3	2.4
FD20-XX-K8- XXX.XXX	1500	1500	22.1	11.1	0.4	2.8
FD20-XX-KC- XXX.XXX	1000	1000	33.2	13.1	0.3	3.2

Speed vs Load

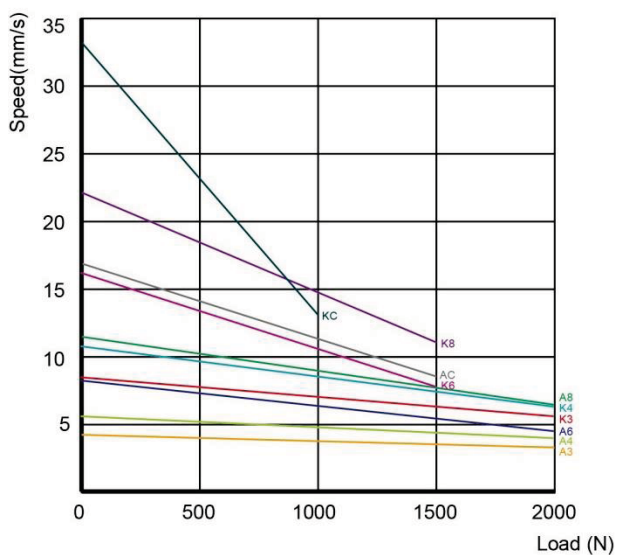

Current vs Load

24V DC

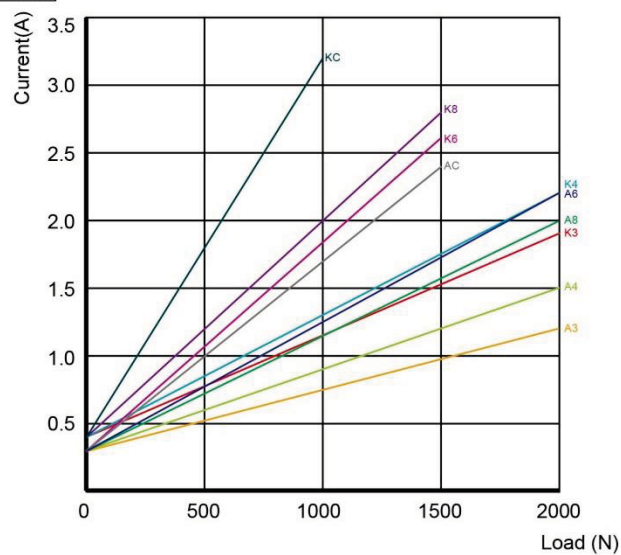

Dimensions

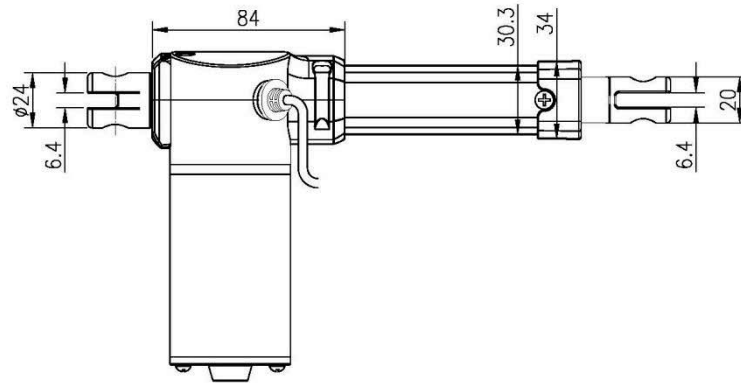
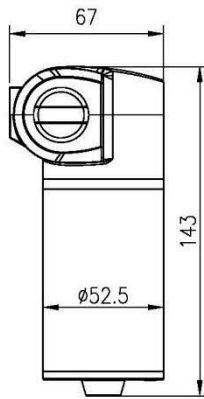
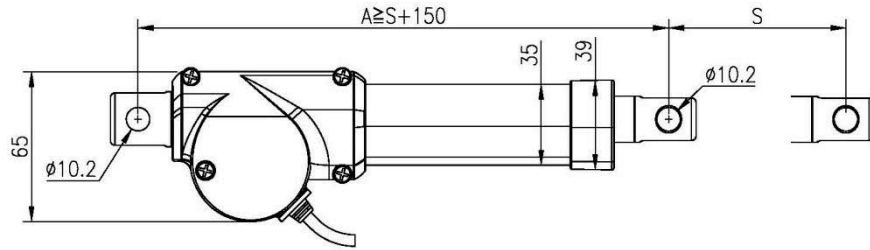

Unit: mm

◆ Front Connector

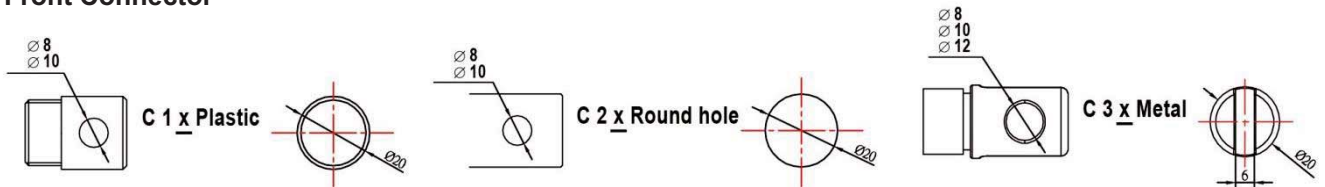

◆ Rear Connector

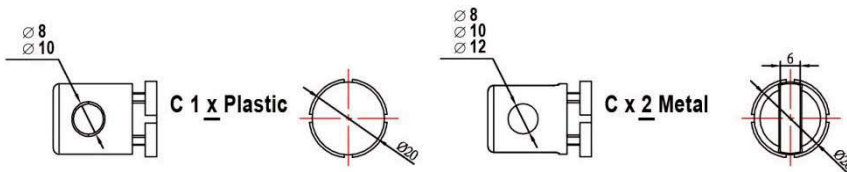

◆ Available stroke (S) range = 50~250mm

◆ Retracted length (A)

Front connector = C1x, C2x \geq stroke + 135mm

Front connector = C3x \geq stroke + 150mm

◆ Extended length = S + A

Ordering Key

FD20—□□—□□—□□□.□□□—C□□—□□□

Input Voltage
24 : 24V DC

Motor and Spindle Type
A3, A4, A6, K3, K4,
A8, K6, AC, K8, KC
(Refer to Performance Data)

Retracted Length
(Refer to paragraph Dimensions)

Extended Length
(Refer to paragraph Dimensions)

Front Connector
1 : Plastic
2 : Round hole
3 : Metal

Rear Connector
1 : Plastic
2 : Metal

Option
HS1 : Hall effect sensor x 1
HS2 : Hall effect sensor x 2



北京泰瑞恩商贸有限公司
Beijing Torion Trading Co.,Ltd.

Tel:13801253818 Fax:010-84067150
www.torion.cn sales@torion.cn