

Actuator

BD60



Features

- ◆ BD60 is a quiet and powerful actuator designed for use in furniture, homecare and fitness equipment. The actuator block allows a big stroke range in confined spaces. The small fitting dimensions make BD60 an ideal solution for recliners with lifting assistance.
- ◆ Main applications : furniture, homecare, and fitness equipment
- ◆ Input voltage : 24V DC / 12V DC
- ◆ Max. load : 6000N (push) / 4000N (pull)
- ◆ Max. current : 6A @ 12V DC, 3A @ 24V DC
- ◆ Max. speed at no load : 33.3 mm/sec
- ◆ Max. speed at full load : 2.9 mm/sec @ 6000N
- ◆ Stroke : 100~1600mm
- ◆ Duty cycle : 10% or 2 min continuous operation in 20 min.
- ◆ Color : Black
- ◆ Certified : EN61000-6-1 / EN61000-6-3 / EN61000-4-2 / EN61000-4-3 / EN61000-4-8
IEC61000-4-2 / IEC61000-4-3 / IEC61000-4-8
- ◆ Noise Level : \leq 53dB
- ◆ Adjustable limit switches

Options

- ◆ Positioning signal feedback with Hall effect sensor x 1
- ◆ Positioning signal feedback with Hall effect sensor x 2

Compatibility

1. Control box

With positioning feedback	CB3T, CB4M
Without positioning feedback	T control, CSI, TR11, TL01

Pin Assignment

1x or 2x Hall sensors
for positioning

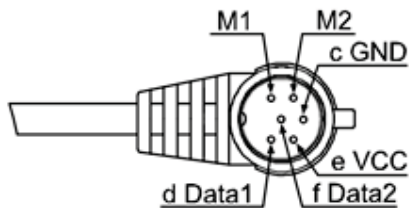

M1(+) & M2(-) : Extends
Pin 'Data2' is defined for 2x Hall sensors only

No sensor feedback

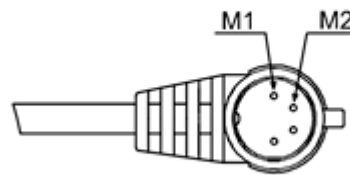

M1(+) & M2(-) : Extends

2. Handset

HA, HC, HD, HJ, HM, H2N, H3N

3. Accessory

None

Performance Data

Model No.	Push Max. (N)	Pull Max. (N)	Speed (mm/s)		Current (A)			
			No load	Full load	No load		Full load	
					12V	24V	12V	24V
BD60-XX-F3- XXX.XXX	6000	4000	4.1	2.8	1.2	0.6	5.2	2.6
BD60-XX-A4- XXX.XXX	6000	4000	4.2	2.9	0.8	0.4	5.4	2.7
BD60-XX-F4- XXX.XXX	5000	3500	5.5	4.4	0.8	0.4	5.6	2.8
BD60-XX-A6- XXX.XXX	4000	3000	6.2	3.8	0.4	0.2	5.0	2.5
BD60-XX-F6- XXX.XXX	4000	3000	8.2	6.6	1.0	0.5	5.6	2.8
BD60-XX-A8- XXX.XXX	3000	2500	8.3	5.0	0.6	0.3	5.4	2.7
BD60-XX-F8- XXX.XXX	3000	2500	11.0	8.2	1.0	0.5	5.8	2.9
BD60-XX-AG- XXX.XXX	1500	1500	16.6	12.2	0.4	0.2	5.6	2.8
BD60-XX-KG- XXX.XXX	750	750	33.3	23.5	0.4	0.2	5.2	2.6

Speed vs. Load

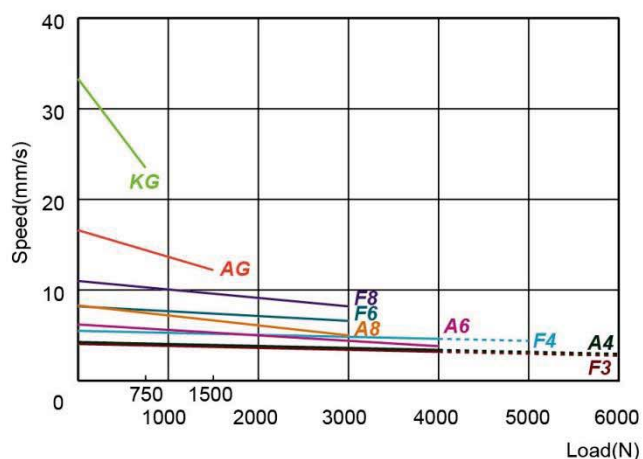

Current vs. Load

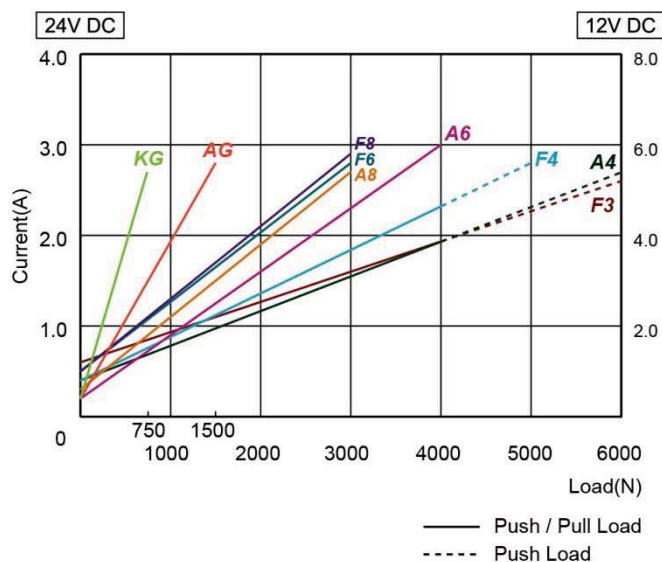

Dimensions

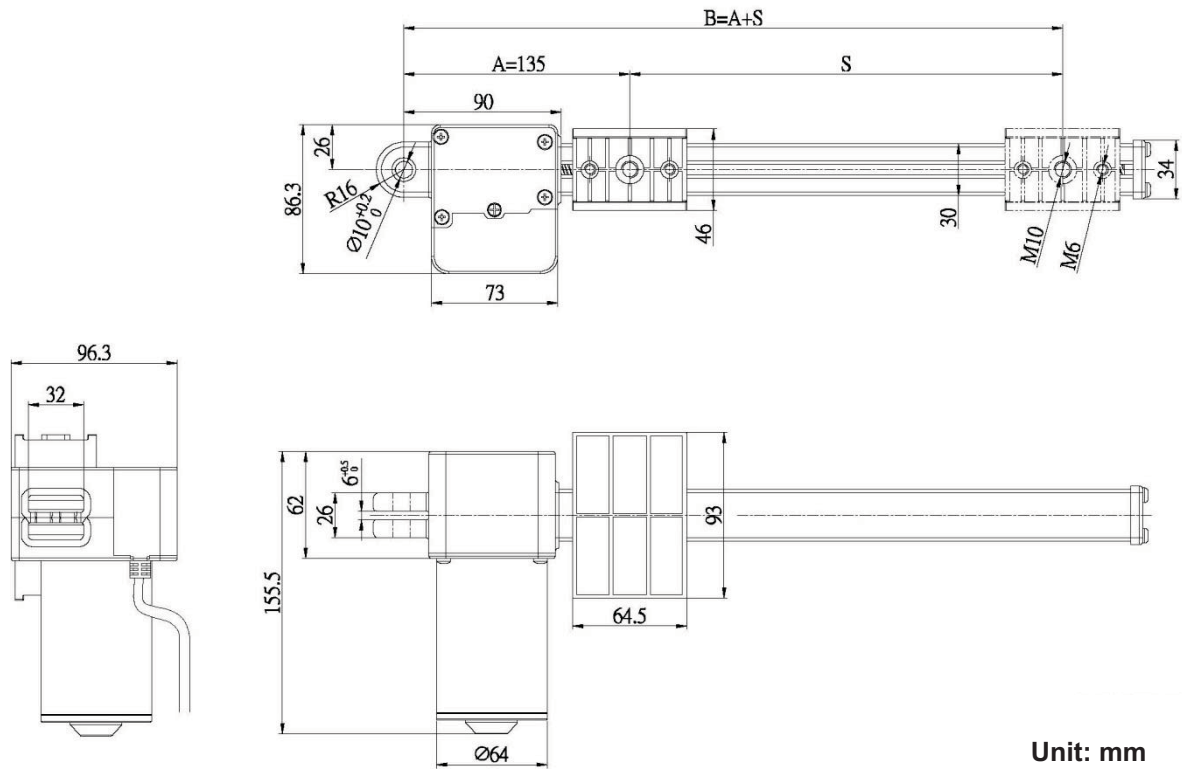

Unit: mm

◆ **Front Connector**
C1x Plastic nut

◆ **Rear Connector**
Cx1 Plastic

◆ **Available stroke (S) range = 100~1600mm**

Model No.	Max. stroke(mm)	Model No.	Max. stroke(mm)
BD60-XX-F3- XXX.XXX	300	BD60-XX-A8- XXX.XXX	800
BD60-XX-A4- XXX.XXX	400	BD60-XX-F8- XXX.XXX	800
BD60-XX-F4- XXX.XXX	400	BD60-XX-AG- XXX.XXX	1600
BD60-XX-A6- XXX.XXX	600	BD60-XX-KG- XXX.XXX	1600
BD60-XX-F6- XXX.XXX	600		

◆ **Retracted length (A) = 135mm Min.**

◆ **Extended length (B) = A + S**

Ordering Key

BD60—□□—□□—□□□.□□□—C□□—□□□

Input Voltage

24 : 24V DC
12 : 12V DC

Motor and Spindle Type

F3, A4, F4, A6, F6, A8, F8, AG, KG
(Refer to Performance Data)

Retracted Length

(Refer to paragraph Dimensions)

Extended Length

(Refer to paragraph Dimensions)

Front Connector

1 : Plastic

Rear Connector

1 : Plastic

Options

HS1 : Single Hall effect sensor
HS2 : Dual Hall effect sensor



北京泰瑞恩商贸有限公司
Beijing Torion Trading Co.,Ltd.

Tel:13801253818 Fax:010-84067150
www.torion.cn sales@torion.cn